



# (Plot 94) 29 Grassland Way

Buckingham Fields, Northampton

oriordanbond  
TOWN & COUNTRY



## (Plot 94) 29 Grassland Way

Buckingham Fields

Northampton NN4 8UA

OFFERS OVER £340,000

A new detached family home built by Messrs Barry Howard Homes in this sought after location, close to Delapre Park in an elevated position, with views across Northampton town.

Accommodation includes entrance hall, cloakroom/WC, fitted kitchen, large sitting/dining room, first floor landing, master bedroom with en-suite, three further bedrooms and family bathroom. The property benefits from uPVC double glazing, gas radiator heating, off road parking and a detached garage. There is an open plan front garden and enclosed rear garden. (A/1000/M)

### Additional information

- Council Tax Band: D
- Energy Efficiency Rating: B

### Viewing

Viewing strictly by appointment – details below

### Disclaimer

O’Riordan Bond Estate Agents Limited has not tested apparatus, equipment, fittings or services and so cannot verify they are in working order. The buyer is advised to obtain verification from their solicitor or surveyor.

O’Riordan Bond Town and Country Sales

01604 766007

tandcnpton@oriordanbond.co.uk

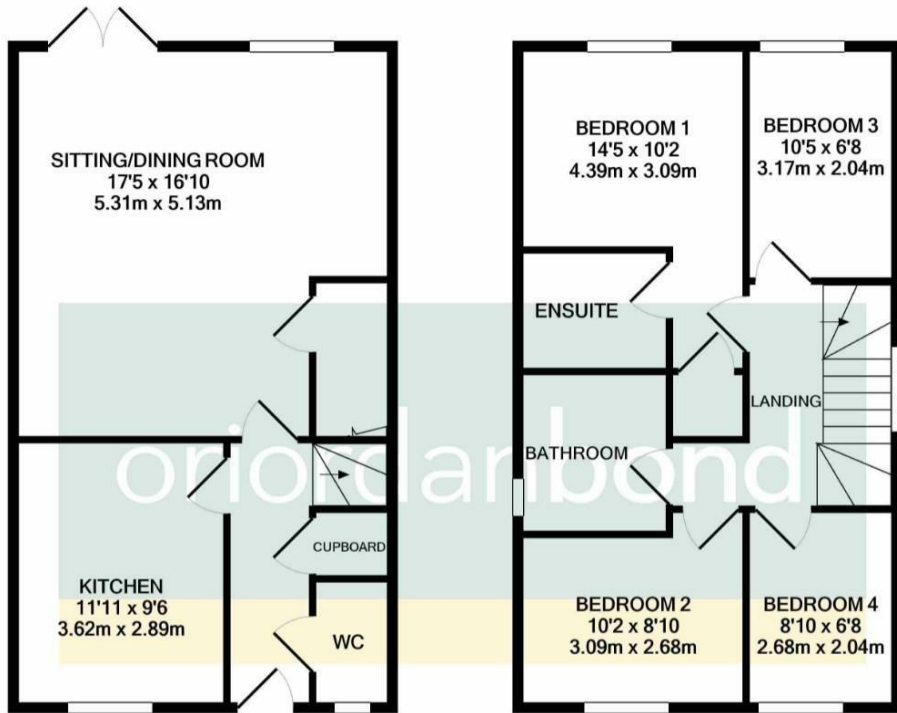

GROUND FLOOR

1ST FLOOR

TOTAL APPROX. FLOOR AREA 1000 SQ.FT. (92.9 SQ.M.)

Whilst every attempt has been made to ensure the accuracy of the floor plan contained here, measurements of doors, windows, rooms and any other items are approximate and no responsibility is taken for any error, omission, or mis-statement. This plan is for illustrative purposes only and should be used as such by any prospective purchaser. The services, systems and appliances shown have not been tested and no guarantee as to their operability or efficiency can be given

Made with Metropix ©2021